

# **Silent Gliss® Blackout Cassette Roller Shade Systems**



# Silent Gliss®

## Blackout Cassette Roller Shade System

### 401OT - Motorized

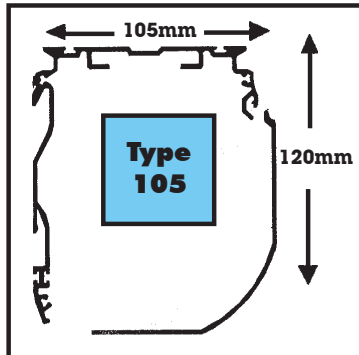
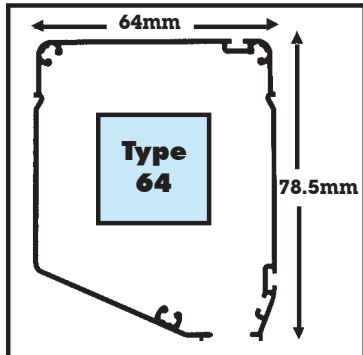

#### Product Information:

- Fully enclosed cassette guarantees total blackout while giving roller shade a beautiful finished look
- Fast and easy installation
- Telescopic, yet small and elegant side channels
- Rivet-system prevents shade from coming out of side channels
- Available in clear and bronze anodized, as well as white finish
- Internal brushes clean fabric while opening and closing shade
- 110V AC or 12/24V DC motor
- Operation from single or multiple wall switch
- Optional infra-red remote control, timer or sun sensor
- 5 year warranty
- Cassette sizes available:



Refer to separate chart for limitations

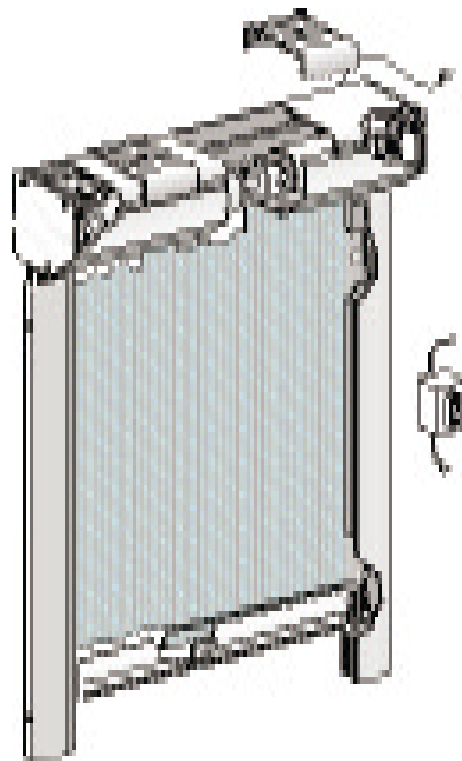

# Silent Gliss®

## Blackout Cassette Roller Shade System 401OT - Motorized

### Assembly and Installation:

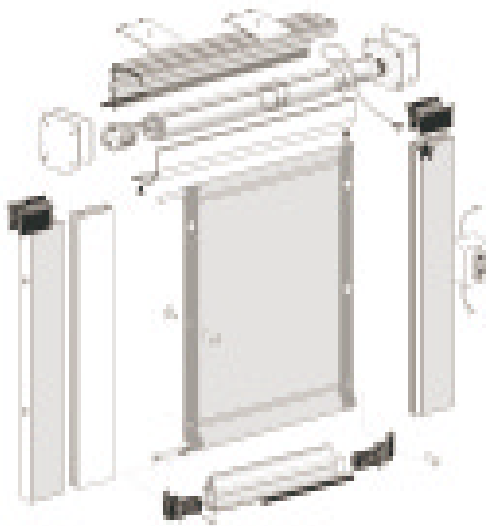

#### Ceiling Mount Bracket



Type 64 = 20006



Type 105 = 81054

#### Wall Mount Bracket



Type 64 = 20007



Type 105 = 40195 / 20105

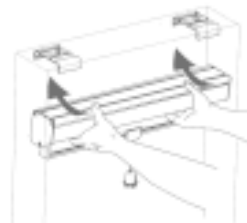

### Technical Information and Optional Components:

Low Voltage Motor  
#4260



12/24V DC

Inside Mount Side Channel



110Volt Motor  
#4460



Wiring Diagram

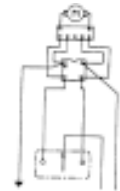

Face Mount Side Channel



Standard Motor  
80W/0.7Amp (4Nm)

Heavy Duty Motor  
150W/1.3Amp (10Nm)  
(with switch #68-SP1)

Remote Control #5765 DC



Remote Control #5765 AC

