

Hand Drawn Curtain Track System Silent Gliss® 6010

6010

1:1

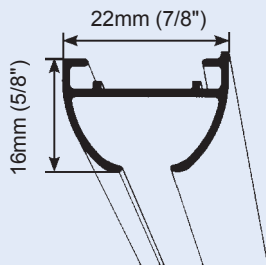

Product Information

- #6010 is a medium duty hand drawn drapery track
- Recommended for ceiling mounted installations
- Elegant, aesthetically pleasing look
- Unique mounting technique with hidden, invisible swing clamps
- Concave gliding channel allows for smooth and easy movement of drapes
- Curvable on both inside and outside radii, to a min. radius of 300mm (12")
- Accommodates Pinch Pleat, S-fold or Z-fold drapery headings (see section "appendix" for additional S/Z-fold information)
- Available in standard clear anodized or optional white painted finish
- Particularly suitable for:
 - Homes / Apartments
 - Offices
 - Hospitals
 - Nursing Homes
- 5 Year Limited Warranty

Bending & Stacking Possibilities

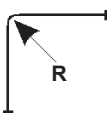
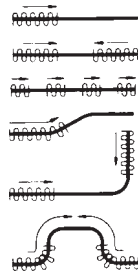

Min. radius R
6010 = 300mm (12")

Installation

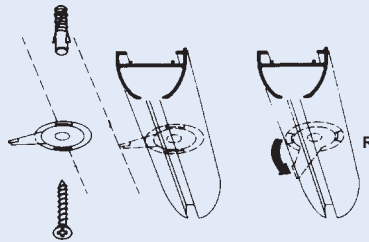

Screw clamps #3825 to ceiling, spaced evenly at approx. 60cm (24") o.c., starting as close to ends as possible. Fix track over clamps (R=Roomside). Rotate clamps counter-clockwise to lock track into place.

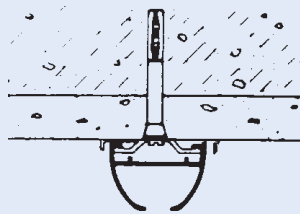

Ceiling mounted onto plaster and concrete

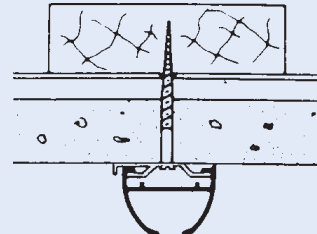

Ceiling mounted onto suspended ceiling, using wooden blocking. (Into T-bars: Use self-tapping screws.)

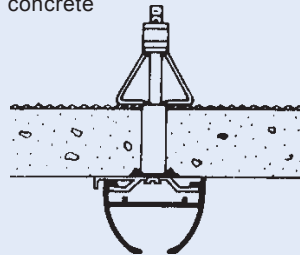

Ceiling mounted onto plaster and metal lath



Mounting of connecting bridge #3802

Standard Components



6283
Roller
Glider



6053
Springstop



6065
Eyelet
Endstop



6013
Endstop



3825
Swing Clamp

Optional Components



6098
Roller
with Eye



6083
Glider



3832
Bracket for
Wall Mount -
Curved System



3555
Sew-in
Adjustable
Hook



3700
Baton
100cm (36")
3750
Baton
120cm (48")

S-fold/Z-fold
components
refer to
section
"appendix"

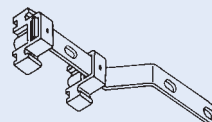

6063
Overlap
Bracket

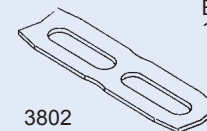

3802
Connecting
Bridge