

Roller Blind Systems

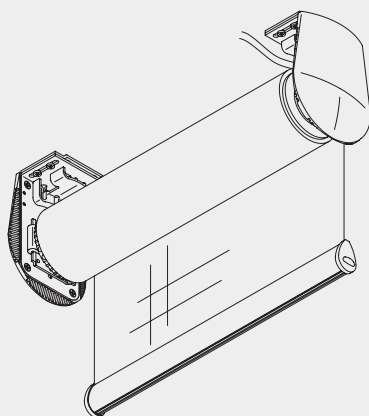

Electrically Operated Roller Blind System

Silent Gliss® 4880



Product Information

- Very heavy duty motorised Roller Blind system. Ideal for contract use.
- With Silent Gliss 4880, extremely large windows can be covered by one single motorised system.
- Patented Silent Gliss Quick Twist permits easy on-site adjustments of the headrail to minimise fabric roll off (only available on systems up to 4m wide).
- Adjustable stainless steel bracket set: the vertical adjustment facility enables the fabric to be easily aligned with the window frame, or the system with the ceiling on-site using only a screwdriver.
- Pre-fitted hook-on stainless steel plates take the weight of the blind during final positioning of the brackets. These are each laterally adjustable sideways by up to 18mm.
- The blind is then conveniently fitted from below (especially important in a blind box situation).
- Electronic end stop.
- Optional side-guide wires with easy fitting and tensioning.
- Bracket covers for neater appearance outside recess.
- For systems over 4m wide a 110mm diameter tube is used to minimise bowing (profile 4957).
- Can be combined with Radio Remote Control System Silent Gliss 9940/0450.



4880

Profile and Specification Information

Profile 4901 (80mm tube diameter)

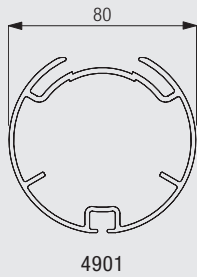

Profile 4957 (110mm tube diameter)

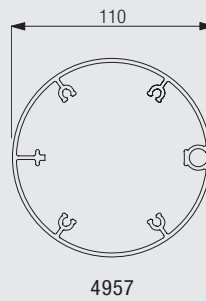

Specification Guide - download from www.silentgliss.co.uk (password required).

Silent Gliss 4880 electrically operated roller blind system for very heavy duty applications. Assembled complete with anodised aluminium headrail and stainless steel bracket combination set 4944 incorporating hook on plates to take weight of blind during fitting. Fix to wall/ceiling/inside recess. Incorporating SG patented QuickTwist for easy on site adjustment of the headrail to prevent fabric roll off. Powered 230V 50Hz motor situated left side incorporating a progressive limit switch unit. Provided with 0615 switch and 0766 in-line connector as standard. Fabrics to be selected from Silent Gliss range.

How to Measure

Measurement information with profile 4901 (80mm tube)

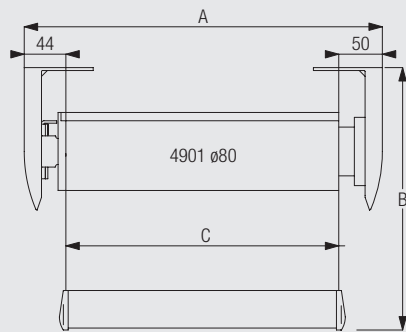

- A: system width
- B: system drop
- C: fabric width

Attention: when installing the blind without bracket covers left and right the total system width will be reduced by 30mm (2 x 15mm)

System measures are indicated with bracket covers. Please refer to Maximum Surface Area Chart for exact total maximum measures of system.

Measurement information with profile 4957 (110mm tube)

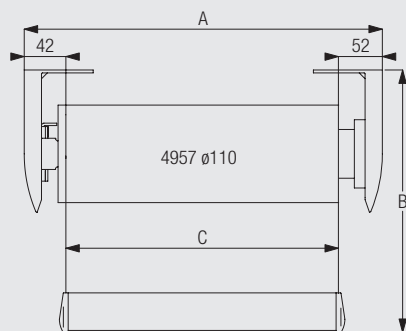

- A: system width
- B: system drop
- C: fabric width

Attention: when installing the blind without bracket covers left and right the total system width will be reduced by 30mm (2 x 15mm)

System measures are indicated with bracket covers. Please refer to Max. Surface Area Chart for exact total maximum measures of system.

System Dimensions



4m with 4901 tube
5m with 4957 tube



72cm



12m with 4901 tube
9m with 4957 tube



36



23kg with 4901 tube
23kg with 4957 tube

Maximum surface area chart

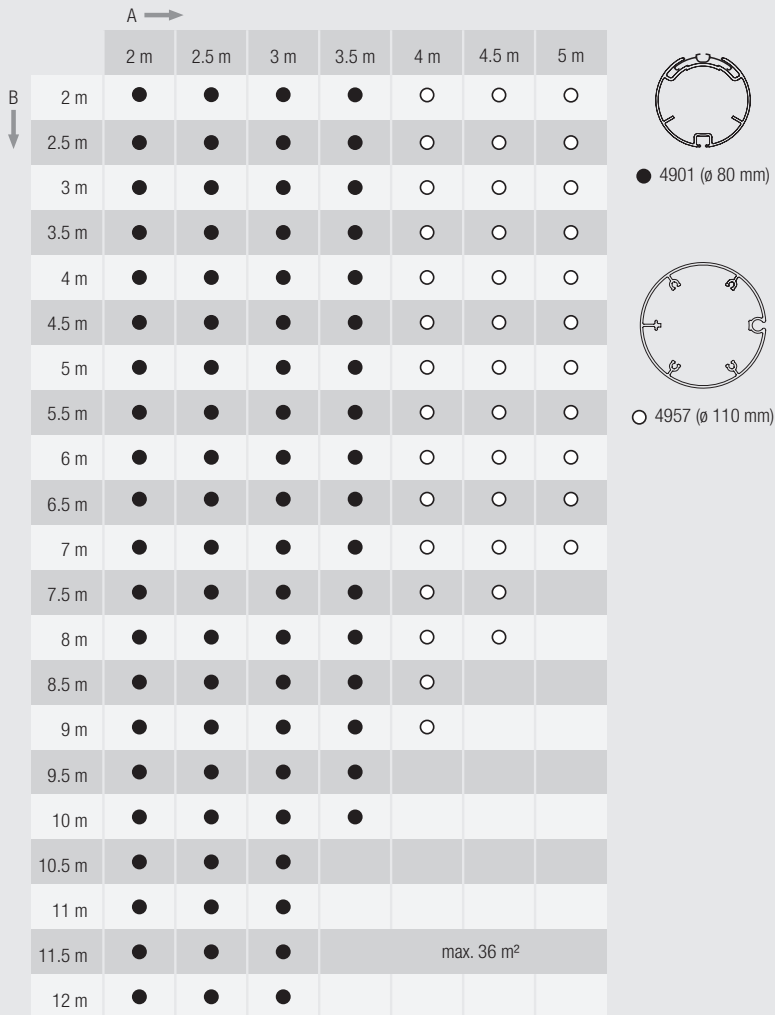

The maximum surface always depends on available fabric widths and fabric weight. As of a width of 4m the system 4880 is supplied with the profile 4957 (110mm tube).

System Options

Side guides for stabilizing blind system

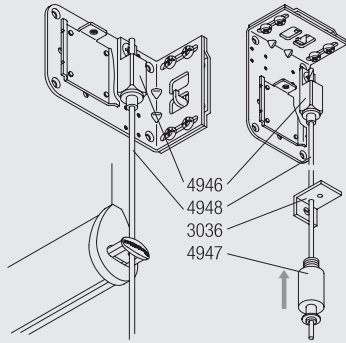

- 4946 Top fastener
- 4948 Wire rope (1.5mm)
- 3036 Bracket
- 4947 Bottom fastener

The bracket 3134 (with cover 3133) can be used as an alternative to 3036 for greater clearance.

Fitting Information

Bracket positioning and basic fitting features

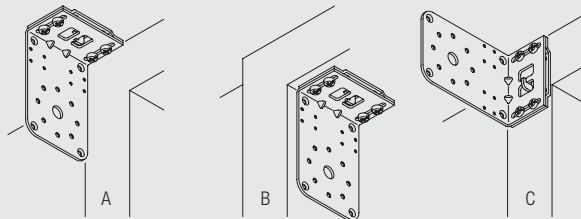

- A: Ceiling fix
- B: Recess fix
- C: Wall fix



4880

Silent Gliss Quick Twist (patented)

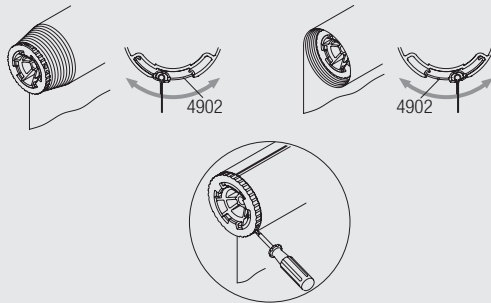

Adjustment feature for fabric rolling off adaptations.

Patented Silent Gliss Quick Twist permits easy on-site adjustments of the heatrail to minimise fabric roll off (only available on systems up to 4m width, using the 80mm tube 4901.)

Hook-in installation plates

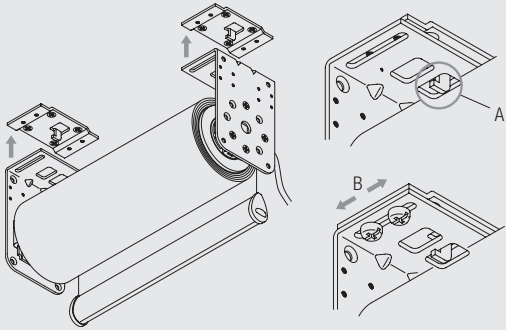

The brackets can be laterally adjusted by up to 18mm.

Specially designed pre-fitted hook-in plates (A) take the weight of the blind during final positioning (B) of the brackets.

Adjustable stainless steel bracket set (for vertical adjustments)

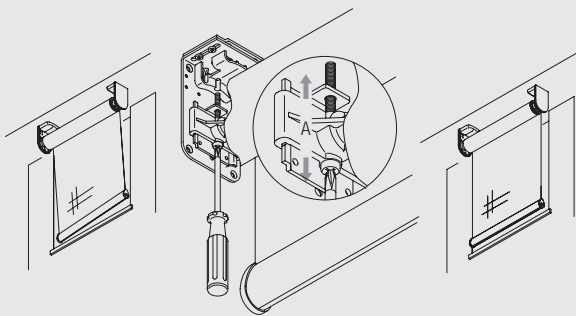

Vertical adjustment of the system (A) allows the headtube to be levelled.

Fitting Options

CAD download from www.silentgliss.co.uk (password required).



4880

Ceiling fix (profile 4901; 80mm tube)

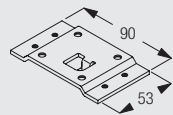
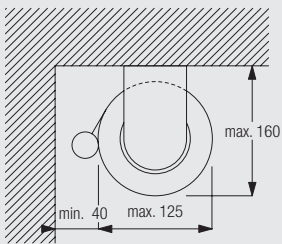

4905
Plate

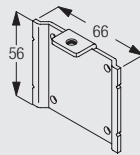

4942
Plate

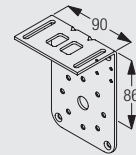

4904
Bracket (131mm)

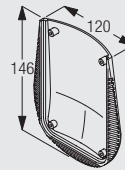

4907
Bracket cover
(146mm)

The fitting key parts shown above are part of bracket set 4949.

Ceiling fix (profile 4957; 110mm tube)

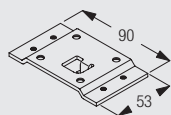
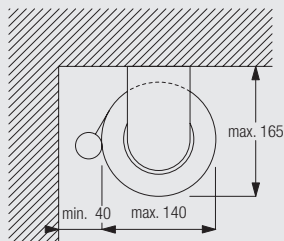

4905
Plate

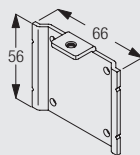

4942
Plate

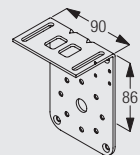

4904
Bracket (131mm)

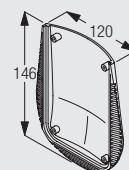

4907
Bracket cover
(146mm)

The fitting key parts shown above are part of bracket set 4949.

Recess fix (profile 4901; 80mm tube)

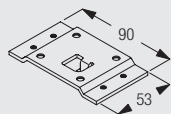
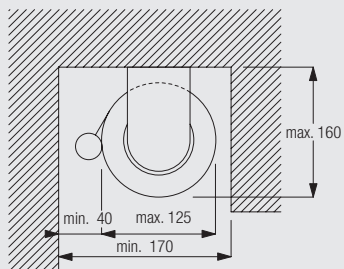

4905
Plate

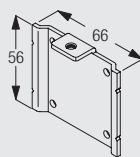

4942
Plate

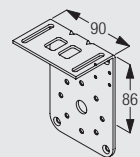

4904
Bracket (131mm)

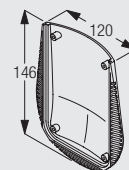

4907
Bracket cover
(146mm)

The fitting key parts shown above are part of bracket set 4949.

Recess fix (profile 4957; 110mm tube)



4880

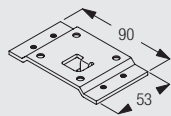
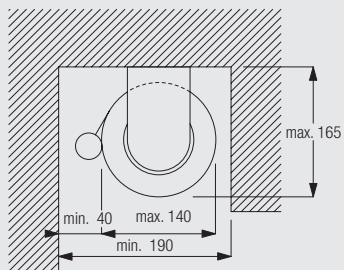

4905
Plate

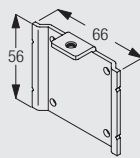

4942
Plate

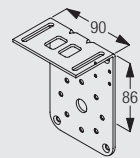

4904
Bracket (131mm)

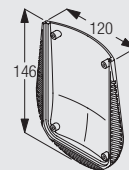

4907
Bracket cover
(146mm)

The fitting key parts shown above are part of bracket set 4949.

Wall fix (profile 4901; 80mm tube)

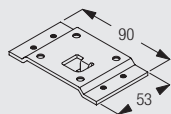
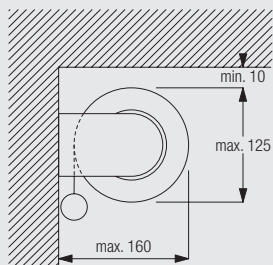

4905
Plate

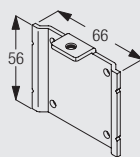

4942
Plate

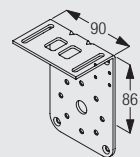

4904
Bracket (131mm)

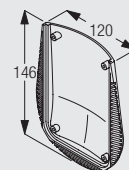

4907
Bracket cover
(146mm)

The fitting key parts shown above are part of bracket set 4949.

Wall fix (profile 4957; 110mm tube)

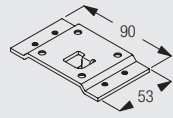
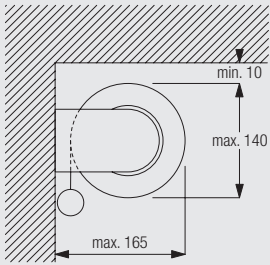

4905 Plate

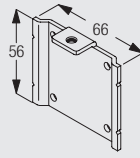

4942 Plate

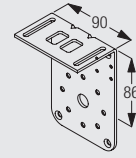

4904 Bracket (131mm)

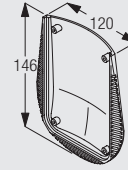

4907 Bracket cover (146mm)

The fitting key parts shown above are part of bracket set 4949.

Standard Accessories

0766	In-line connector (complete/no lead)		4901	Profile	
4902	Profile		4903	Bottom bar	
4907	Bracket cover (146mm)		4939	Shaft	
4943	Acrylic rod (ø4mm)		4957	Profile	
4963	Acrylic rod (ø6mm)		10326	Motor 20-Series, 230V	

Sets



4949	Bracket set, containing		4904	Bracket (131mm)	2	
			4905	Plate	2	
			4942	Plate	1	
			4966	Special screw	1	

Optional Accessories

0578	Pattress box		0615	Latching switch inc. pattress box	
0997	Motor Test Lead		3036	Bracket (47mm)	

3133	Bracket cover (60mm)	
4946	Wire rope top fastener	
4948	Wire rope (ø 1,5mm)	
5741	Klik plug	
9943	Wall switch	
9948	Wall switch	
10298	Sensor	
10302	Hand-held transmitter, 5+1 channel	
10327	Motor 20-Series, 230V, radio receiver	

3134	Extension bracket (60mm)	
4947	Wire rope bottom fastener	
4951	Gear Set	
5742	Klik socket	
9946	Wall switch	
10297	Solar Sensor	
10300	Hand-held transmitter, 1 channel	
10303	Hand-held transmitter, 10+2+1 channel	



Overview Motors & Controls

Motor and Control Features	Motor
	10326, 10327

Motor Features

Mechanical end-stop programming with adjusting tool	
Electronical end-stop programming with Silent Gliss transmitters or non-latching switch	•
Electronical revolution counter (unlimited revolution)	•
Two intermediate positions possible (only applicable with built-in motor receiver)	•
Exact programming of intermediate positions possible	•
Parallel wiring possible without additional relays	•
Parallel wiring possible without additional relays with built-in motor receiver	•
Soft stop	•
No stop clicking	•
Cable connectable with plug into motor and available in different lengths	•

Control Features

Silent Gliss Radio Remote Control System 9940 (only applicable with built-in motor receiver)	•
Silent Gliss Radio Remote Control System 0450 (external receiver necessary)	•
Suitable for all common home automation and bus systems	•

Motorisation

Motors Silent Gliss 10326/10327

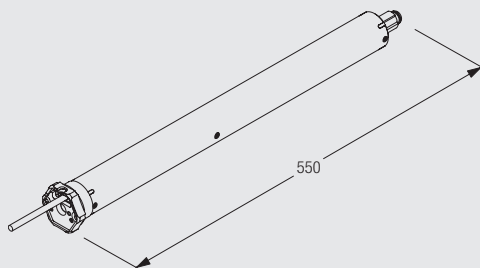

- Voltage: 230V
- Frequency of Receiver of Motor 10327: 868MHz
- Torque: 15Nm
- Speed: 23rpm
- Frequency: 50Hz
- Power: 200W
- Current: 0.90A
- Thermal overload protection
- CE Standard
- Cable pluggable



4880

Operating Methods

Operation via fixed switch with motor 10326

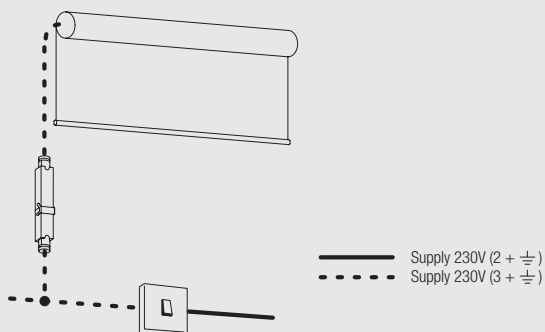

Up to 10 motors can be wired in parallel, cumulative total load must be 25% below the switch/fuse rating.

When using the Fixed Switch control for multiple blinds, when operating simultaneously the blinds may not necessarily stop at precisely the same intermediate point. Top and bottom levels can be preset in alignment.

If this is a requirement of the system then it is recommended that System 9940/0450 Radio Controls is used with individual and simultaneous switching.

Operation with Radio Remote Control System 9940 with motor 10327 (integrated receiver)

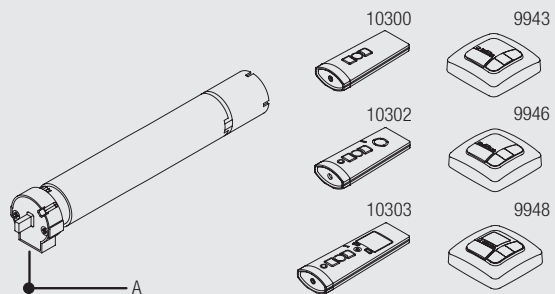

A: 230V

The 10327 motor with integrated receiver can be operated directly with hand-held transmitters Silent Gliss 10300, 10302, 10303 and wall switches Silent Gliss 9943, 9946 and 9948.

Operation with System 0450 Radio Controls with motor 10326

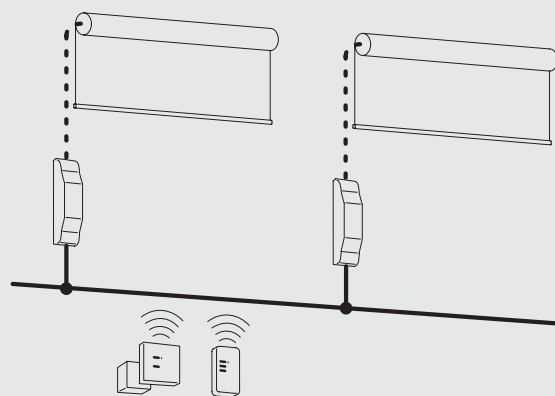

The Silent Gliss System 0450 allows the System 4880 to be operated via fixed switch or hand-held remote controls. For more information on the wide range of controls refer to the Switches section of this catalogue.



4880

— Supply 230V (2 + $\frac{1}{2}$)
 - - - Supply 230V (3 + $\frac{1}{2}$)

Wiring and Connections

Important: Wiring Diagrams are available from www.silentgliss.co.uk (password required).

www.bradingfabrication.com

Brading Fabrication Limited
3204 Yonge Street
Toronto, ON, Canada
M4N 2L2

Tel: 416-488-6600
Fax: 416-488-9821
info@bradingfabrication.com